

2011 RV Rentals:

Our rental fleet is 2008 & 2012 models. We strive to keep our rental fleet in top shape and continuously rotate our fleet out to keep up with the newest equipment and models available. We have a minimum rental of 3 days. Pick Up times are Monday through Friday 9am to 3:30pm from our Rockford Location only until June 1st 2011. This allows enough time for your 45 minute RV Orientation which will teach you how to use the motor home from front to back and everything in between!

Booking:

We require a \$500 booking deposit to hold your rental and at the time of pick up you will pay for the remaining balance of the rental cost plus an additional \$1,000, for the Refundable Damage Deposit. This deposit will be refunded back within 7-10 business days once the RV is returned with no damage, additional mileage, generator time, or a gasoline charge.

Contact our RV Rental Representative for additional mileage fee's and availability.

Generator:

We give you 5 free hours of generator time per day with a \$3.00 and hour charge there on after. While driving or staying at a campground that does not have electricity you will have to run the generator in order to power the following items: Roof top A/C unit, television, DVD player, microwave, and plug outlets.

Your furnace, refrigerator/freezer, water, and interior lights will work with just the battery, assuming the battery is charged, which happens as you drive the vehicle or have the vehicle plugged in to an electric source.

Mileage Tier:

0-100 Miles Per Day – Free

101 – 300 Miles Per Day – 40 Cents Per Add Mile

300+ Miles Per Day – 75 Cents Per Additional Mile

Each Rental Day Includes 100 Miles

Quick Start Package

\$95.00 – Includes Hoses, Adapters, Chemicals, Toilet Paper and 45 minute RV orientation. Quick Start Provision Package is required to acquaint the customer and drivers with the operation of the vehicle before departure. This package consists of RV Toilet tissue, chemicals, fresh water hose, electrical adaptor, sewer hose, vehicle preparation, fresh water and propane tanks filled, and free vehicle parking at Collier RV Super Center. The RV Orientation is given to familiarize the customer with the different aspects of the RV and basic operational information. This will take approximately 30 minutes to one hour depending on customer.

Collision Damage Waiver:

We offer a \$15 per day Collision Damage Waiver: limits your responsibility for collision damage to the motor home to \$1,000.00.

Refundable Damage Deposit:

\$1,000 is Paid in addition to rental fees which will be refunded back once the RV is returned without damage.

What Does The RV Come With?

The RV is equipped with the typical things that are required for RV operation: Fresh water hose, waste hose, and an electrical adapter. We do not supply any: Linens, cookware, cleaning products, etc.

To Avoid Additional Charges:

What do I have to do when returning the vehicle to avoid additional charges?

We allow you to bring the vehicle back the way we gave it to you. What does that mean? Well you receive the RV in the following condition: Interior clean, exterior clean, full gas tank, and empty waste tanks. You will be required to return the unit in the same condition to experience no additional fees associated with these items.

Is Towing Allowed?

Yes, you can tow as long as what you are towing is less than 5,000 pounds. There is an additional \$95 fee for wear and tear and we do not provide any tow equipment.

You will need to provide the shank and ball, electric plug and tow dolly if you choose to tow a vehicle.

2011

Rental Season

**Let Your Family
Traditions Begin Here**



Collier RV

7373 Harrison Ave
Rockford, IL 61112

815-332-3322
www.collierrv.com

I94rv

16125 Russell Rd
Russell, IL 60075

847-395-9500
www.i94rv.com

Thor Class A Motorhome



2012 Thor ACE 29.1 EVO

\$275 Per Day

Length: 29' 7"

MPG: 8-10

Seats and Sleeps up to 7 people

Fuel: 80 gal



2008 Gulf Stream Independence

\$221 Per Day

Length: 33'

MPG: 7-9

Seats 7 and Sleeps Up To 5 People

Available at i94rv only after June 1st

Class C Motorhome

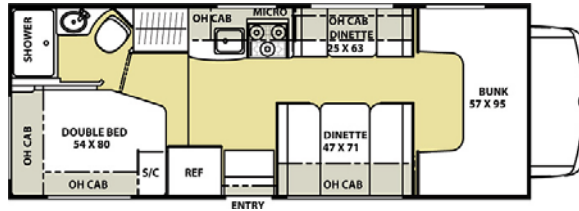

2012 Coachmen Frelander 23CB

\$225 Per Day

Length: 25' 8"

MPG: 8-10

Seats and Sleeps Up To 6 People

Fuel: 55 gal

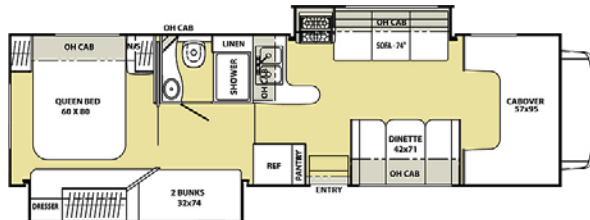

2012 Coachmen Frelander 32BH

\$275 Per Day

Length: 32' 5"

MPG: 8-10

Seats and Sleeps Up To 8 People

Fuel: 55 gal

Class C Motorhome

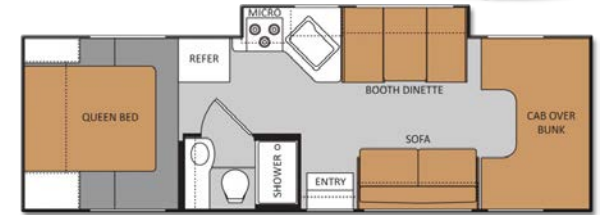

2012 Four Winds Chateau 28Z

\$250 Per Day

Length: 29' 10"

MPG: 8-10

Seats and Sleeps up to 7 people

Fuel: 55 gal



2008 Gulf Stream Conquest

\$199 Per Day

Length: 31'

MPG: 8-10

Seats and Sleeps Up To 7 People

Available at i94rv only after June 1st